



Product line

# MILITARY ACCOMMODATION TENTS

Temporary and flexible  
troop accommodation tents



**HTS**  
TENTIQ





# Contents

## 4 Accommodation and shelters

- 6 Emergency P Tents UKMZ-M
- 8 Inflatable Tents ABZ-M
- 10 Troop Tents TRZ-M
- 12 Large Tents GZ-M

## 14 Accommodation and shelters – Carbon

- 16 Carbon Troop Tents CTZ-M
- 18 Carbon Large Tents CGZ-M

## Who we are

HTS TENTIQ creates spaces for great things – because we believe an ideal space solution exists for every sector and every application. For many years we have been making an impact in the tent industry as experts in development, manufacturing, quality, selection, technology, customer service and innovation made in Germany. We produce temporary and innovative space solutions for your future – and within the shortest possible time.

Our wide range of products leaves nothing to be desired. We implement custom designs and sector-specific solutions quickly and easily thanks to our comprehensive technical expertise. On the basis of continuous product development and a focus on flexibility, quality, sustainability and reliability, we are able to offer our customers the best products in the sector along with premium service worldwide. However, HTS TENTIQ not only creates space, but also adds value. To this end, we always keep the big picture in mind. Our environment is just as important to us as our employees and fellow human beings. Benefit from our years of experience and let us advise you. Our highly qualified staff always knows exactly which tent system suits you best.





# Accommodation and shelters

Whether as an accommodation tent, command post or work area, our accommodation tents are multifunctional and will meet even the most demanding requirements. In addition, they can be quickly connected to other tents and containers, enabling you to easily expand your available space. We offer our Emergency P Tent systems in different standard sizes. They can be individually configured to withstand local conditions.



## Emergency P Tents UKMZ-M

This robust tent variant meets the usual military standards. It can be adapted to specific country, region and climate requirements. The plug-in system ensures quick and easy set up and dismantling. Due to the different cover types, the tents can be flexibly adapted to a wide range of weather conditions and challenges. They can also be individually configured in terms of size, design and accessories for each application.



## Troop Tents TRZ-M

These lightweight aluminium tents are particularly flexible in use, whether as accommodation tents, command posts or medical units. They can also be connected to other tents and containers. This tent system can be adapted to any local conditions and is suitable for all types of military operations.



## Inflatable Tents ABZ-M

Innovative "ABZ-M" Inflatable Tents are suitable for military operations worldwide. They are extremely versatile and allow for quick set up. The tent can be set up by 1 or 2 people within 5 minutes. The design allows for a wide variety of applications and includes an extensive range of accessories.



## Large Tents GZ-M

"GZ-M" Large Tents offer large-area spaces for a wide variety of purposes. The Large Tents are equipped with an extruded aluminium frame that can easily withstand high snow and wind loads. These tent systems are built to standard military specifications and can be adapted to meet country-specific requirements. They are supplied in various sizes and unlimited lengths. These large military tents can be packed and transported in 20-foot containers and, depending on size and configuration, they can be set up in just a few hours.





# Emergency P Tents UKMZ-M

You can always rely on our tent constructions. We developed our Emergency P Tents in order to provide you with the right accommodation for your troops on site. The Emergency P Tent’s plug-in system guarantees quick and easy assembly and disassembly with little effort and prior knowledge. These shelters can be equipped with various accessories such as floor coverings, partition walls or connecting walkways, and can also be flexibly adapted to suit a wide range of weather conditions and

challenges. Our designs provide ample space for any military operation, whether you need a tent for a small group of 4 to 6 people or for 20 people. You can choose from nine different standard sizes with lengths from 4.00 m to 12.00 m – the maximum size of our Emergency P Tents is around 70 m². However, special sizes are available upon request. The set up time of this tent system is only around 15 minutes with a team of 3 people.

## Specifications

- Quick set up and dismantling
- Simple plug-in system without the need for tools
- Breathable cotton-polyester cover
- Attractively priced
- High number of variations and equipment options

## Size table

Type	Span width m	Length m	Eave height m	Ridge height m	Area m²	Number of beds
P10	4.75	5.00	1.70	2.50	23.75	4-6
P11	5.90	4.00	1.90	2.90	23.60	6
P12	5.65	6.00	1.70	2.70	33.90	10
P13	5.90	6.00	1.90	2.90	35.40	10
P16	5.65	8.00	1.70	2.70	45.20	12
P17	5.90	8.00	1.90	2.90	47.20	12
P20	5.65	10.00	1.70	2.70	56.00	16
P21	5.90	10.00	1.90	2.90	59.00	16
P22	5.90	12.00	1.90	2.90	70.80	20

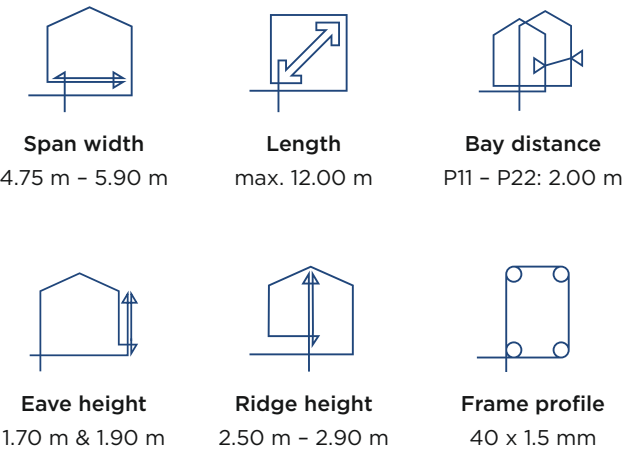

## Roof and side covers

Variant 01	Cotton/polyester
Variant 02	Roof: PVC Side walls: Cotton/polyester
Variant 03	PVC

## Transport volume

Minimum	P10, in cotton/polyester: 2.60 x 0.80 x 0.75 m, approx. 77 kg
Maximum	P22, in cotton/polyester: 2.60 x 0.80 x 1.00 m, approx. 172 kg Longest component: 2.44 m



# Inflatable Tents ABZ-M

Our Inflatable Tents “ABZ-M” are extremely fast and easy to set up. Depending on the size and equipment, it usually only takes 1 to 2 people around 5 minutes. Inflatable shelters are not only quick to set up, but are also extremely versatile. They are perfect for quick shelter or medical care during military operations around the world.

The tent has a width of 5.65 m, a variable length of up to 13.20 m and a side height of 2.27 m. The design allows for versatile use with a wide range of accessory options. Thanks to its low transport volume, the standard inflatable tent can be packed and transported on only one pallet.

## Specifications

- Low transport volume and weight
- Quick set up and dismantling by means of electric air pump or compressed air cylinder at the deployment area
- Ideally suited for short-term deployment
- Can be used for various purposes, e.g. as a shelter, operations centre, etc.
- Can be combined with an identical tent system

## Size table

Type	Span width m	Length m	Eave height m	Ridge height m	Bay distance m
ABZ Ultimate 1	5.65	5.28	2.27	3.00	2.64
ABZ Ultimate 2	5.65	7.92	2.27	3.00	2.64
ABZ Ultimate 3	5.65	10.56	2.27	3.00	2.64
ABZ Ultimate 4	5.65	13.20	2.27	3.00	2.64

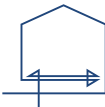

Span width  
5.65 m



Length  
max. 13.20 m



Bay distance  
2.64 m



Eave height  
2.27 m



Ridge height  
3.00 m

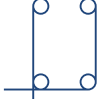

Frame profile  
Air-based



## Number of beds

ABZ 1	4 beds
ABZ 2	6 beds
ABZ 3	8 beds
ABZ 4	10 beds

## Transport volume

ABZ 1	176 kg
ABZ 2	225 kg
ABZ 3	275 kg
ABZ 4	327 kg





# Troop Tents TRZ-M

Do you need a flexible structure that also meets the most exacting requirements? Our Troop Tents are developed from high quality aluminium frames and are multifunctional. They can be used as accommodation tents, command posts or medical units and can be connected to other tents or containers in no time by means of connecting passages. Thanks to our wide range of accessories, you can

configure your tent system according to your wishes. Our designs for military operations can be adapted to a wide range of conditions, no matter how demanding. The tent system can be packed and transported in a 20-foot container. Depending on size and configuration, it can be assembled by 4 people in only around 20 minutes.

## Specifications

- Robust tent system made of extruded aluminium profiles for long-term use
- High wind and snow loads for special regions
- High number of variations and equipment options, such as insulating covers, various floor systems, ballistic protection, etc.
- Can be used for various purposes, e.g. as a shelter, command post, medical unit, etc.

## Size table

Eave height		Span width 3.00 m	4.00 m	6.00 m	8.00 m	9.00 m	10.00 m
2.30 m	Ridge height	2.84 m	3.01 m	3.38 m	3.74 m	3.93 m	4.11 m

Note: All measurements are standard dimensions. Custom-made solutions can be offered, subject to static calculations. Higher wind and snow loads are available upon request, dependent on regional requirements.

**Span width**  
3.00 m – 10.00 m

**Length**  
min. 6.00 m

**Bay distance**  
3.00 m

**Eave height**  
2.30 m – 3.00 m

**Ridge height**  
3.36 m – 4.06 m

**Frame profile**  
94 x 48 x 3 mm



## Roof and side covers

Variant 01	PVC cover (non-insulated)
Variant 02	PVC cover including insulation cover and optional sun protection cover for hot temperatures (medium insulated)
Variant 03	Insulated hard wall system consisting of sandwich panels and PVC cover as well as sun protection cover for hot temperatures (well insulated)

## Transport volume

Standard size 6.00 m x 9.00 m	3.10 m x 1.00 m x 1.50 m, approx.: 685 kg Longest component: 2.75 m
----------------------------------	---



# Large Tents GZ-M

Large Tents “GZ-M” offer various options for canteens, conference rooms, waiting and rest areas. Our wide selection of wall, roof and floor options are available at a variety of prices to meet a wide range of comfort needs. The Large Tents for worldwide military operations are equipped with a frame made of extruded aluminium that can easily withstand even high snow and wind loads. These tent systems are

built according to recognized military standard specifications and can be adapted to country-specific requirements depending on the location. They are also available in various sizes and unlimited lengths. Large Tents “GZ-M” can be easily packed and transported in 20-foot containers and set up within a few hours, depending on size and configuration.

## Specifications

- Span width from 10.00 m to 50.00 m
- High number of variations and equipment options, such as insulating covers, various flooring systems, ballistic protection, etc.

## Size table

Eave height		Span width							
		10.00 m	12.00 m	15.00 m	20.00 m	25.00 m	30.00 m	40.00 m	50.00 m
2.40 m	Ridge height	4.22 m	4.36 m	4.80 m	5.65 m	6.40 m			
3.00 m	Ridge height	4.82 m	4.96 m	5.40 m	6.25 m	7.00 m	7.87 m		
4.00 m	Ridge height			6.40 m	7.25 m	8.00 m	8.87 m	10.35 m	12.00 m

Note: All measurements are standard dimensions. Custom-made solutions can be offered, subject to static calculations. Higher wind and snow loads are available upon request, dependent on regional requirements.

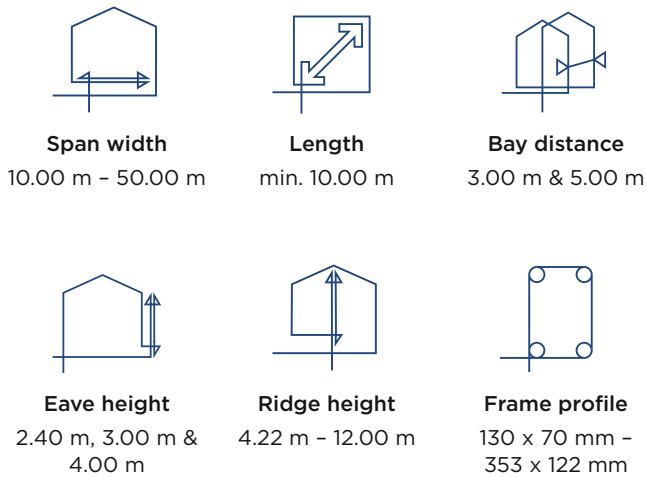

## Roof and side covers

Variant 01	PVC cover (non-insulated)
Variant 02	PVC cover including insulation cover as well as optional sun protection cover for hot temperatures (medium insulated)
Variant 03	Insulated hard wall system consisting of sandwich panels and PVC cover as well as sun protection cover for hot temperatures (well insulated)
Variant 04	Insulated hard wall system consisting of sandwich panels and thermo-roof cover (well insulated)
Variant 05	Insulated wall and roof system consisting of sandwich panels (extremely well insulated, permanent use)

## Transport volume

Example Variant 01	Approx. 1,000 m² tent area on a HGV or 40 ft. container Weight: approx. 12 kg/m²
--------------------	---



# Accommodation and shelters – Carbon

HTS TENTIQ tents with Carbon-Hybrid technology were developed exclusively for the military. Their key features include not only the latest technology, but also state-of-the-art materials and advanced innovations. Our Carbon tents are considered the strongest yet lightest construction of their kind, making them ideal for military operations. The use of Carbon reduces their total weight by up to 35 % and their transport volume by as much as 50 % compared to conventional systems.

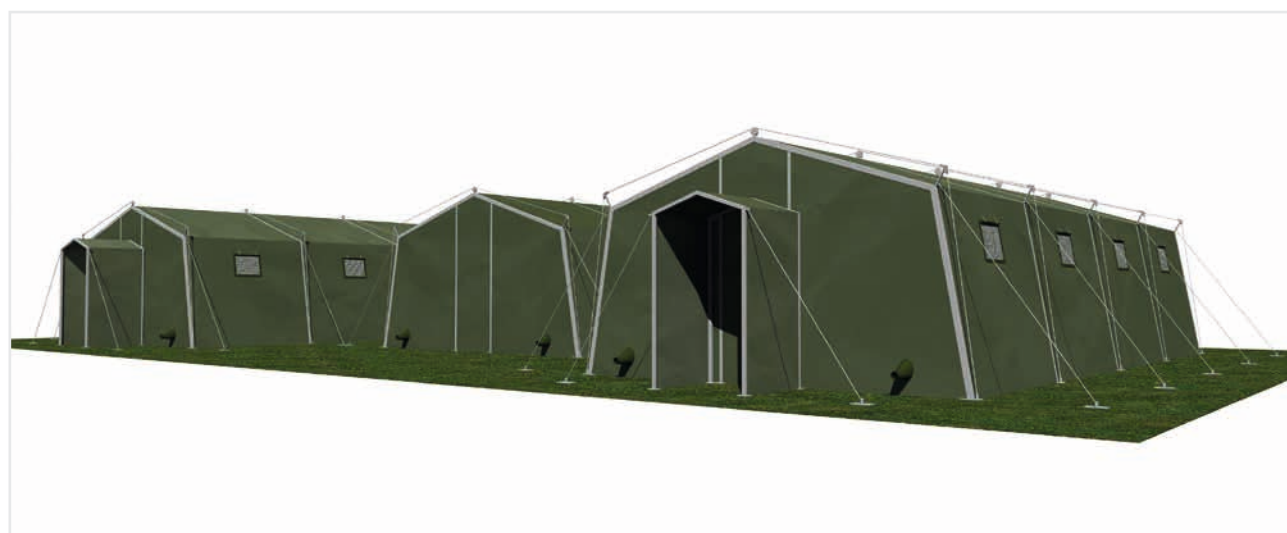

## Carbon Troop Tents CTZ-M

Tents of this type consist of a revolutionary, patented frame system with exceptionally light and stable Carbon-Hybrid aluminium profiles. This technology is also considerably more stable than comparable designs. This enables the tents to withstand higher wind and snow loads.

They are also reliable and quick to set up, which makes them suitable for use as accommodation tents, command centres, canteens and meeting rooms. In addition to standard sizes, individual sizes are offered according to customer specifications.



## Carbon Large Tents CGZ-M

Carbon Large Tents “CGZ-M” made with Carbon-Hybrid technology comprise the latest technology, state-of-the-art materials and innovations. They provide large-area space that is ideal for canteens, conference rooms, waiting and recreation areas. These designs can be used in extreme

temperatures from -40 °C to +80 °C and have already proven themselves in the most extreme weather conditions and environments. Here, too, the size can be adapted to individual requirements.





# Carbon Troop Tents CTZ-M

Innovative Carbon Troop Tents “CTZ-M” are precisely adapted to requirements in the field – their key features include state-of-the-art technology paired with the most modern materials. The patented Carbon-Hybrid system is considerably more stable than comparable constructions and thereby easily withstands even the most extreme requirements. Whether temperatures from -40 °C to 80 °C, strong

winds, snow or rain – our frame system employing the extraordinarily light and stable Carbon technology has proven itself even under the toughest conditions. Standard sizes are available with span widths from 3.00 m to 10.00 m, a side height of 2.30 m and unlimited lengths. In addition to our standard sizes, we also offer custom sizes – feel free to contact us.

## Specifications

- Robust tent system made of Carbon-Hybrid profiles for long-term use
- High wind and snow loads for special regions
- High number of variations and equipment options, such as insulating covers, various flooring systems, ballistic protection, etc.
- Can be used for various purposes, such as accommodation, operations centre, canteen, meeting room, etc.

## Size table

Eave height		Span width					
		3.00 m	4.00 m	6.00 m	8.00 m	9.00 m	10.00 m
2.30 m	Ridge height	2.84 m	3.01 m	3.38 m	3.74 m	3.93 m	4.11 m

Note: All measurements are standard dimensions. Custom-made solutions can be offered, subject to static calculations. Higher wind and snow loads are available upon request, dependent on regional requirements.

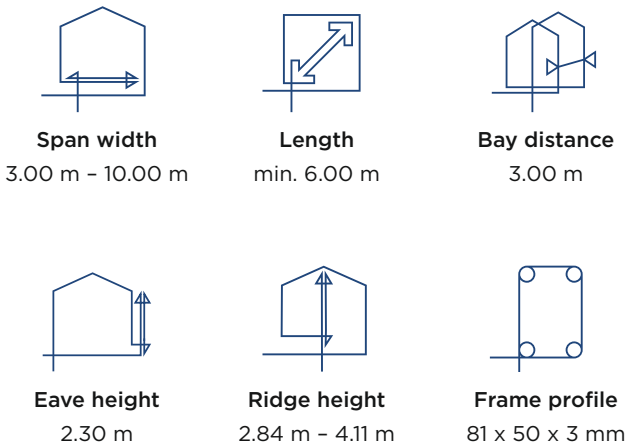

## Roof and side covers

Variant 01	PVC cover (non-insulated)
Variant 02	PVC cover including insulation cover and optional sun protection cover for hot temperatures (medium insulated)
Variant 03	Insulated hard wall system consisting of sandwich panels and PVC cover as well as sun protection cover for hot temperatures (well insulated)

## Transport volume

Standard size 6.00 m x 9.00 m	3.10 m x 1.00 m x 1.50 m, approx.: 548 kg Longest component: 2.75 m
----------------------------------	---



# Carbon Large Tents CGZ-M

Our robust Large Tents “CGZ-M” with Carbon-Hybrid technology offer large spaces that are ideal for canteens, conference rooms or as waiting and recreation areas for military operations around the world. The Carbon-Hybrid profile is probably the most significant innovation introduced to the tent systems market in recent years: the structure’s total

weight is reduced by up to 35 % and transport volume by up to 50 %, compared to conventional systems. Standard sizes are available with span widths from 10.00 m to 50.00 m, side heights from 2.40 m to 4.00 m and unlimited length. In addition to our standard sizes, we offer custom sizes entirely according to customer requirements.

## Specifications

- Span width from 10.00 m to 50.00 m
- High number of variations and equipment options, such as insulating covers, various flooring systems, ballistic protection, etc.

## Size table

Eave height		Span width							
		10.00 m	12.00 m	15.00 m	20.00 m	25.00 m	30.00 m	40.00 m	50.00 m
2.40 m	Ridge height	4.22 m	4.36 m	4.80 m	5.65 m	6.40 m			
3.00 m	Ridge height	4.82 m	4.96 m	5.40 m	6.25 m	7.00 m	7.87 m		
4.00 m	Ridge height			6.40 m	7.25 m	8.00 m	8.87 m	10.35 m	12.00 m

Note: All measurements are standard dimensions. Custom-made solutions can be offered, subject to static calculations. Higher wind and snow loads are available upon request, dependent on regional requirements.

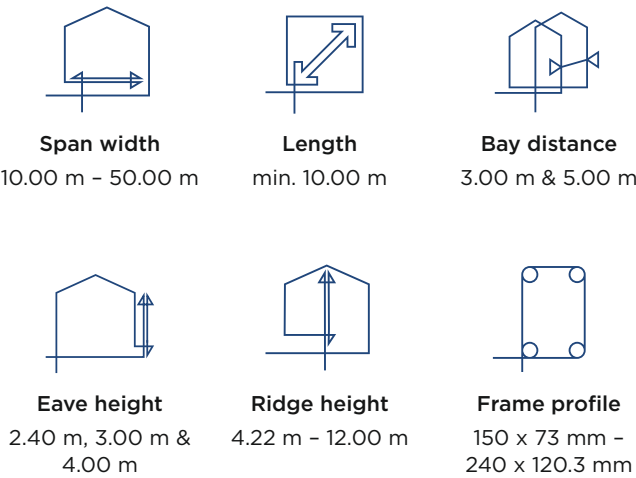

## Roof and side covers

Variant 01	PVC cover (non-insulated)
Variant 02	PVC cover including insulation cover and optional sun protection cover for hot temperatures (medium insulated)
Variant 03	Insulated hard wall system consisting of sandwich panels and PVC cover as well as sun protection cover for hot temperatures (well insulated)
Variant 04	Insulated hard wall system consisting of sandwich panels and thermal roof cover (well insulated)
Variant 05	Insulated wall and roof system consisting of sandwich panels (extremely well insulated, permanent use)

## Transportvolumen

Example Variant 01	Approx. 1,500 m² tent area on a truck or 40 ft. container Weight: approx. 9 kg/m²
--------------------	--





**HTS TENTIQ GmbH**  
Hinter der Schlagmühle 1  
63699 Kefenrod

**T** +49 60 49 - 95 10 0  
[verkauf@hts-tentiq.com](mailto:verkauf@hts-tentiq.com)  
[www.hts-tentiq.com](http://www.hts-tentiq.com)

---

